

ITEM NO.	PART NUMBER	DESCRIPTION	QTY.
1	GS 42 P Rev 2	GS 42 P	1
2	05235058HD00000	Spinweld Flush Fitting, #58HD	2
3	05235060HD00000	Spinweld Flush Fitting, B1160H	1
4	05235060HD00003	Plug #P-3B, Black, 3"	1
5	05190PPA55TGK93	Plug, 2" Polyvisegrip w/gasket	2

REVISIONS						
ECR/ECN	REV.	DESCRIPTION	DATE	DRWN	CHK'D	APPRV
	1	Drawing Created	12/4/2025	BRS	--	---
	2	Added Mash TL 2, removed draft on Fork Pockets	2/26/2026	BRS	--	---

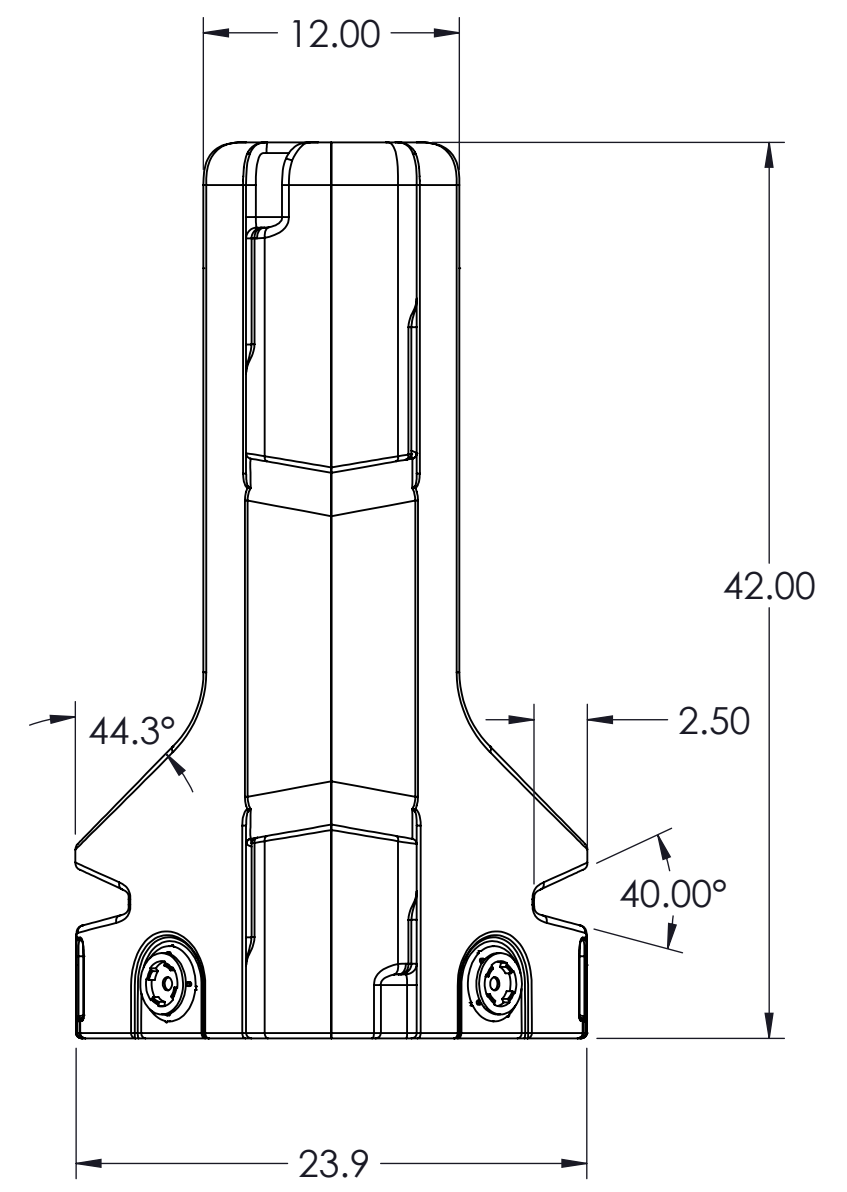
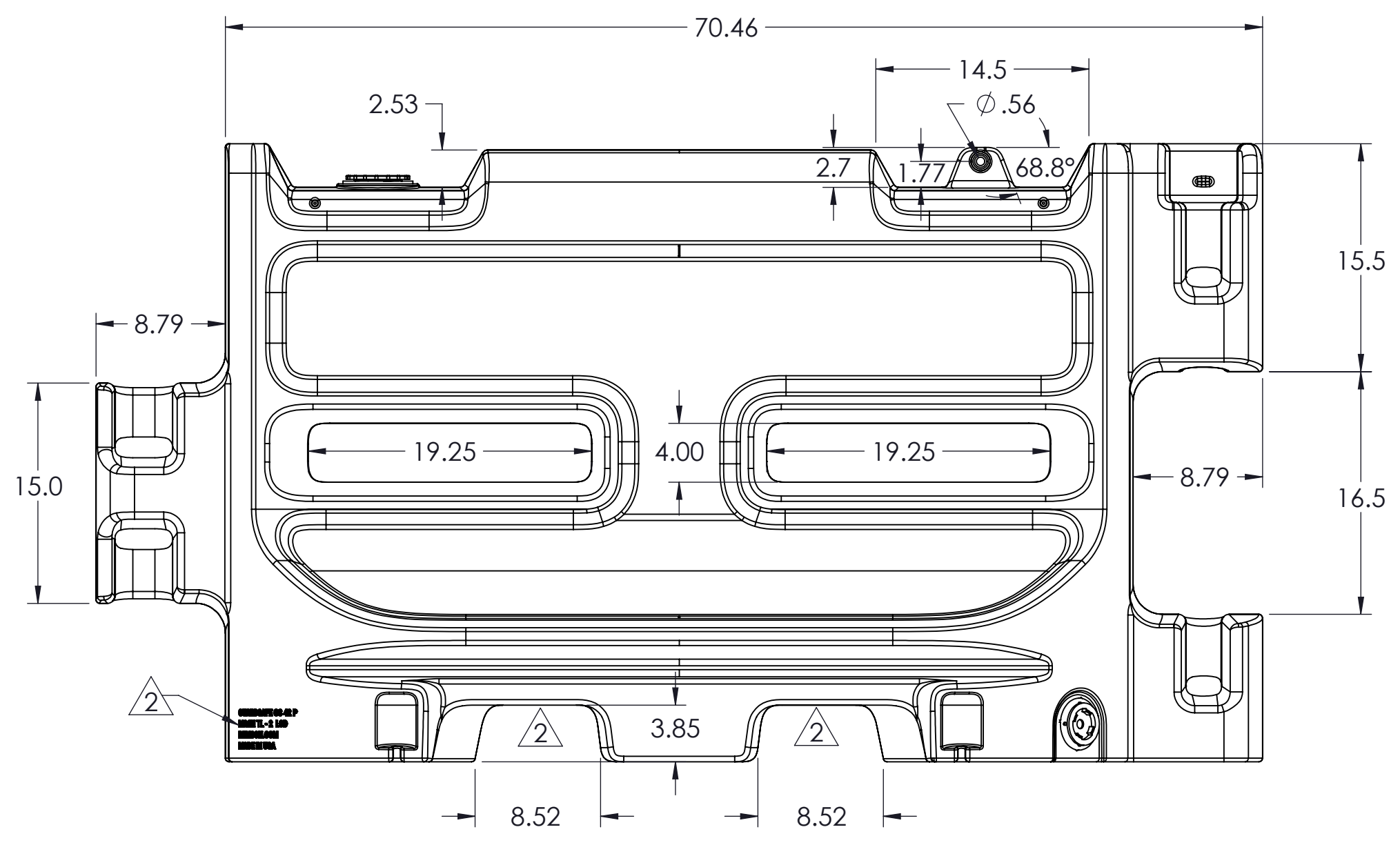
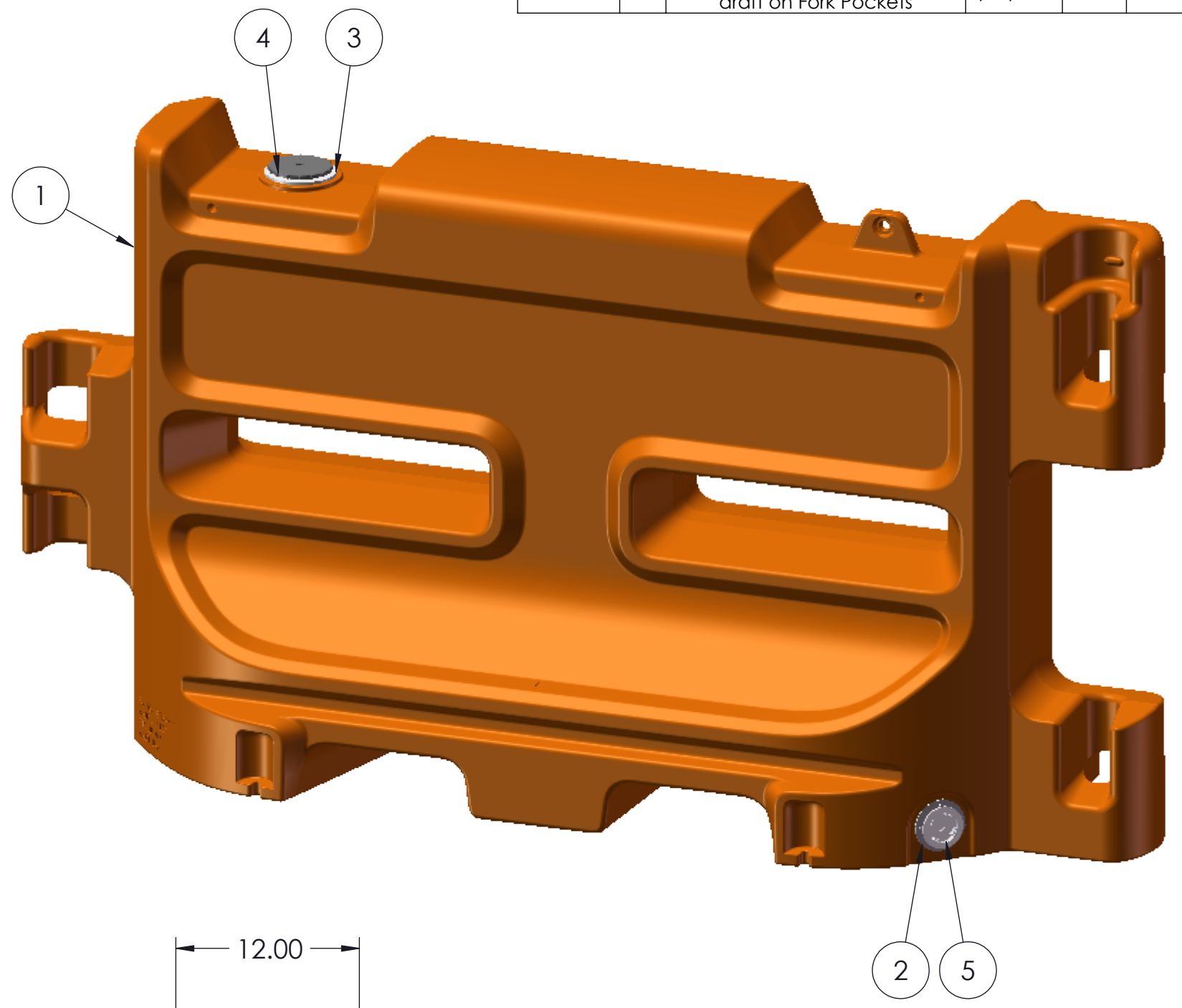
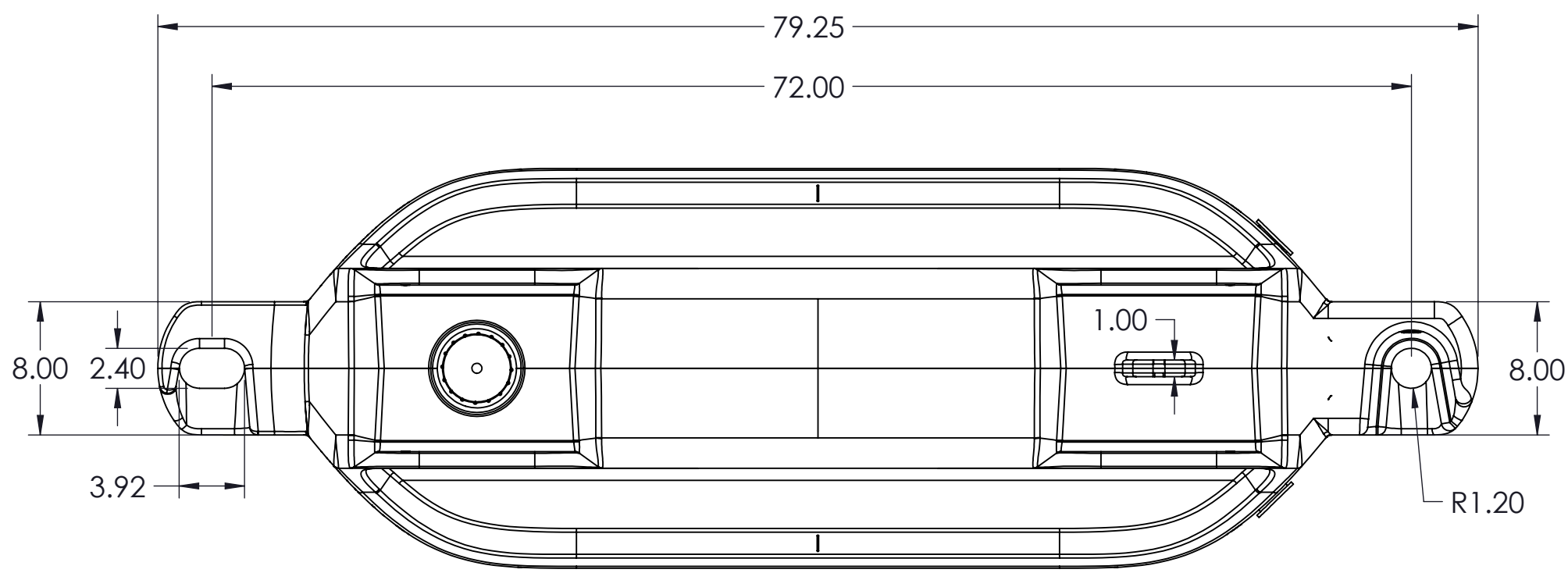

<p><b>PROPRIETARY AND CONFIDENTIAL</b></p> <p>THE INFORMATION CONTAINED IN THIS DRAWING IS THE SOLE PROPERTY OF REMCON PLASTICS, INC. ANY REPRODUCTION IN PART OR AS A WHOLE WITHOUT THE WRITTEN PERMISSION OF REMCON PLASTICS, INC. IS PROHIBITED.</p>	<p>UNLESS OTHERWISE SPECIFIED, ALL DIMENSIONS ARE IN INCHES</p> <p>TOLERANCES:</p> <table border="1"> <thead> <tr> <th>DECIMAL</th> <th>INCH</th> <th>(MM)</th> </tr> </thead> <tbody> <tr> <td>.X</td> <td>±.1</td> <td>(±2.5)</td> </tr> <tr> <td>.XX</td> <td>±.01</td> <td>(±.25)</td> </tr> <tr> <td>.XXX</td> <td>±.005</td> <td>(±.13)</td> </tr> </tbody> </table> <p>FRACTIONAL ANGULAR SURF. FINISH ±1/32 ±1/2° 63/</p> <p>REMOVE ALL BURRS AND BREAK SHARP CORNERS .01/.02, MIN/MAX</p>	DECIMAL	INCH	(MM)	.X	±.1	(±2.5)	.XX	±.01	(±.25)	.XXX	±.005	(±.13)	<p>CAD GENERATED DRAWING, DO NOT MANUALLY UPDATE</p> <table border="1"> <thead> <tr> <th>APPROVALS</th> <th>DATE</th> </tr> </thead> <tbody> <tr> <td>DRAWN BRS</td> <td>12/04/25</td> </tr> <tr> <td>CHECKED</td> <td>--</td> </tr> <tr> <td>APPRV</td> <td>---</td> </tr> </tbody> </table> <p>MATERIAL:</p>	APPROVALS	DATE	DRAWN BRS	12/04/25	CHECKED	--	APPRV	---	<p><b>GuardSafe 42 P</b></p> <table border="1"> <thead> <tr> <th>SIZE</th> <th>DWG. NO.</th> <th>REV.</th> </tr> </thead> <tbody> <tr> <td>C</td> <td>XXXXXXXXXX</td> <td>2</td> </tr> </tbody> </table> <p>SCALE: 1:9 DO NOT SCALE DRAWING SHEET 1 OF 1</p>	SIZE	DWG. NO.	REV.	C	XXXXXXXXXX	2
		DECIMAL	INCH	(MM)																									
		.X	±.1	(±2.5)																									
		.XX	±.01	(±.25)																									
.XXX	±.005	(±.13)																											
APPROVALS	DATE																												
DRAWN BRS	12/04/25																												
CHECKED	--																												
APPRV	---																												
SIZE	DWG. NO.	REV.																											
C	XXXXXXXXXX	2																											