

8 7 6 5 4 3 2 1

D

C

B

A

D

C

B

A

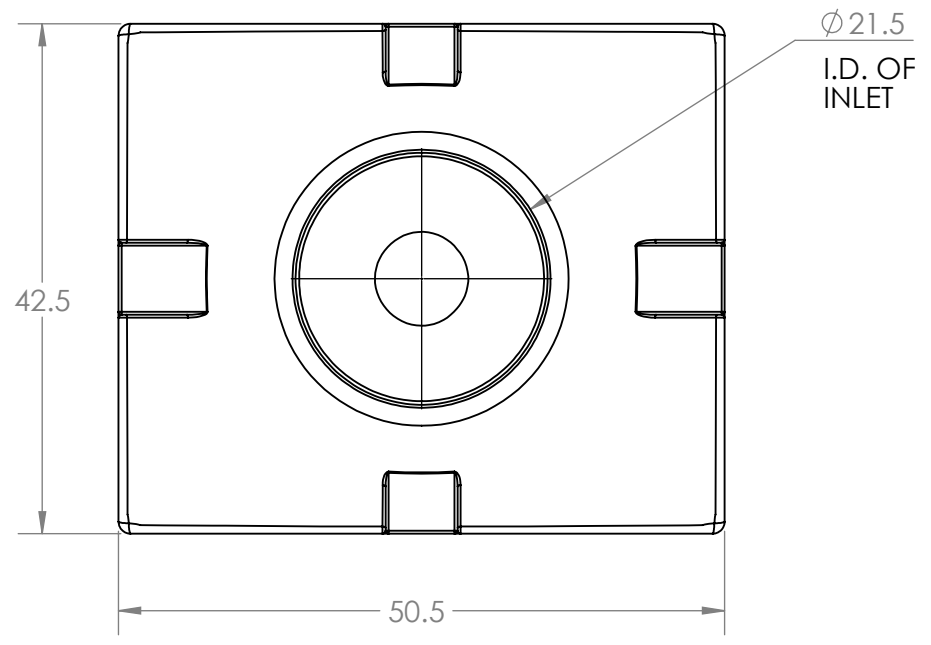

Ø21.5
I.D. OF
INLET

- NOTES:
 1. DRAWING SHOWS FINISHED MOLDED PART
 2. FLANGE TRIM FOR REPRESENTATION ONLY
 3. FLANGE AND VALVE OPTIONS PER ORDER

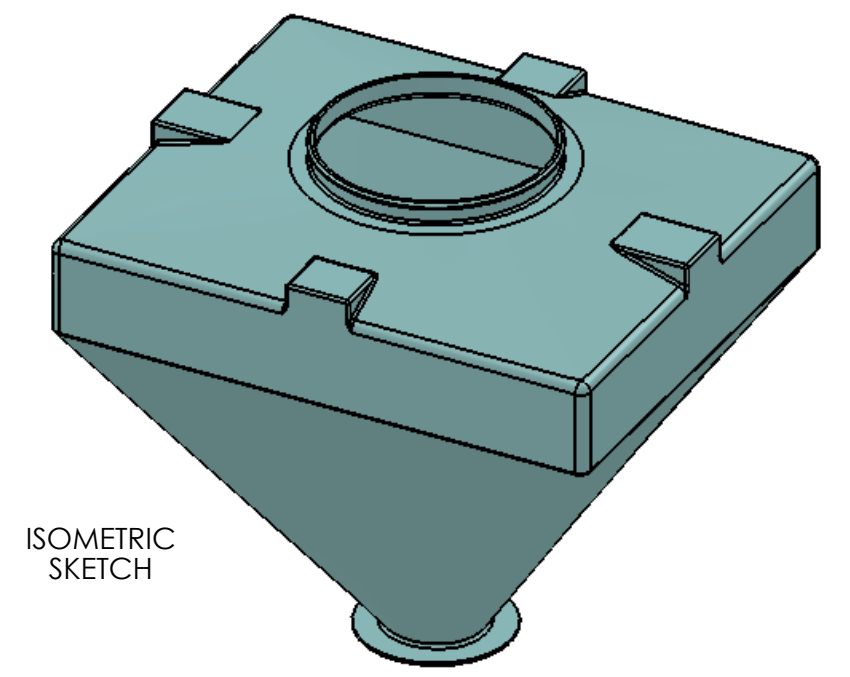

ISOMETRIC
SKETCH

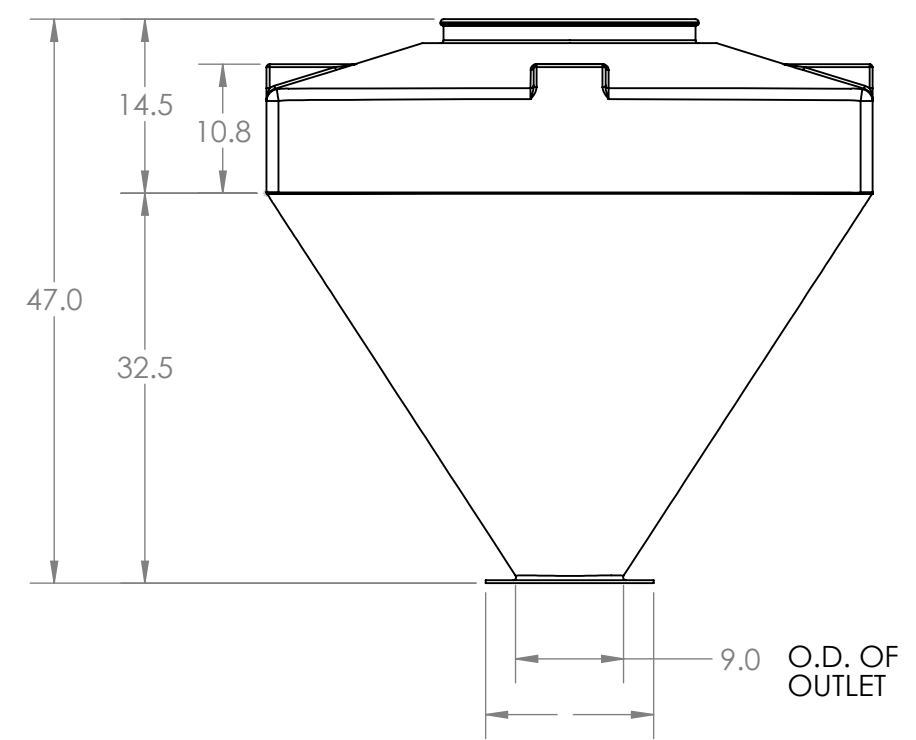

9.0 O.D. OF
OUTLET

TO SUIT
APPLICATION

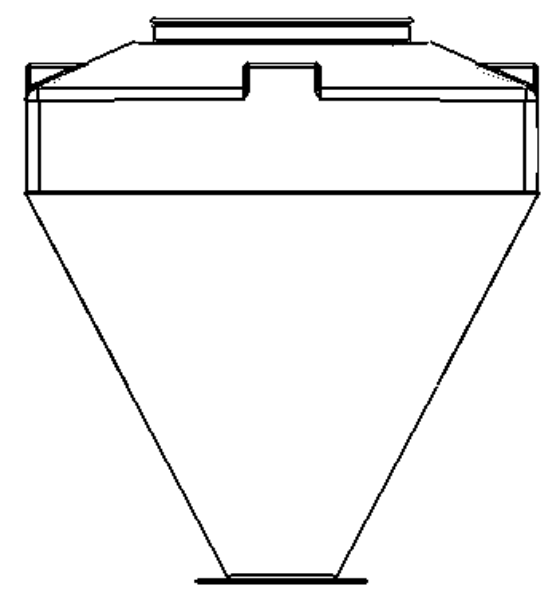

PROPRIETARY AND CONFIDENTIAL
 THE INFORMATION CONTAINED IN THIS
 DRAWING IS THE SOLE PROPERTY OF
 REMCON PLASTICS INC. ANY
 REPRODUCTION IN PART OR AS A WHOLE
 WITHOUT THE WRITTEN PERMISSION OF
 REMCON PLASTICS INC IS PROHIBITED.

		UNLESS OTHERWISE SPECIFIED:		NAME	DATE	Remcon Plastics Inc. 208 Chestnut Street, Reading Pa, 19602		
		DIMENSIONS ARE IN INCHES TOLERANCES: FRACTIONAL: N/A ANGULAR: ±1/2 DEG DECIMAL: ±0.010 in/in		DRAWN	PFE	11/5/14	TITLE: RM-1340 HOPPER BODY AS-MOLDED GENERAL SPECIFICATIONS	
				CHECKED	PFE	11/5/14		
				ENG APPR.	DH	11/5/14		
		PROJECT NUMBER: PROP. UPDATES		COMMENTS:				
		MATERIAL LLDPE				SIZE	DWG. NO.	REV
NEXT ASSY		USED ON				B	01040214001850	A
APPLICATION		DO NOT SCALE DRAWING				SCALE: 1:16 WEIGHT:		SHEET 1 OF 1

8 7 6 5 4 3 2 1