

R1.75
TYP.

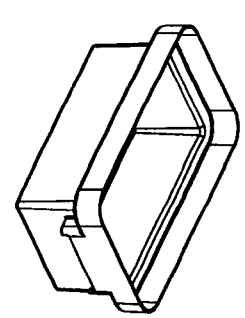

ISOMETRIC SKETCH
(NOT TO SCALE)

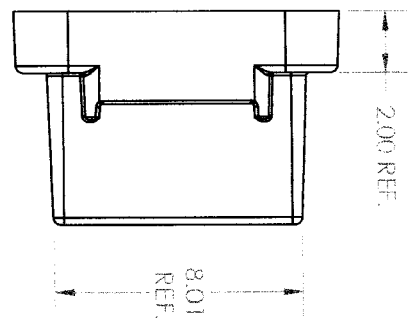
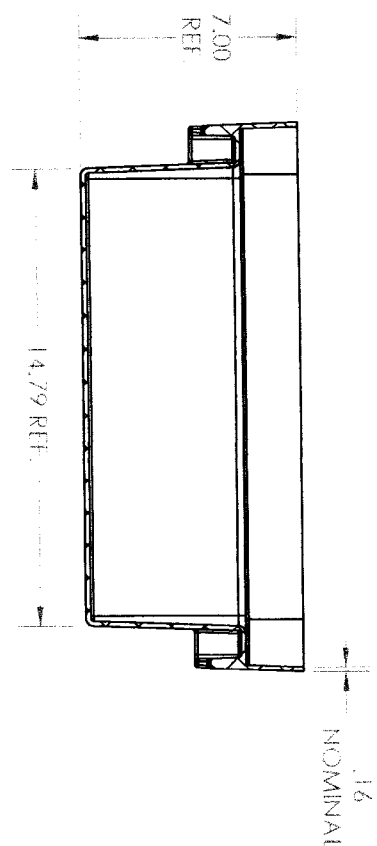

SECTION A-A
SCALE 1:6

- NOTES:
1. DRAWING SHOWS FINISHED MOLDED TOOLING BOX
 2. FIT WITH CORRESPONDING LID AND TRAYS IS CRITICAL
 3. CORRESPONDING LID AND TRAY DETAILS PROVIDED ON SEPARATE DRAWINGS.
 4. DIMENSIONS ARE REFERENCE ONLY -REFER TO SOLID GEOMETRY FOR PART DETAILS AND DIMENSIONS NOT SHOWN.

UNLESS OTHERWISE SPECIFIED:

DIMENSIONS ARE IN INCHES
TOLERANCES:
FRACTIONAL: N/A
ANGULAR: ± 1/2 deg
TWO PLACE DECIMAL: ± 0.030
THREE PLACE DECIMAL: N/A

ENGINEERING PROP. COMMENTS:
PROJECT #: UPDATES
MATERIAL POLYPROPYLENE

FINISH SMOOTH
USED ON APPLICATION
DO NOT SCALE DRAWING

NAME DATE
PFE 5/28/09
PFE 5/28/09
KM 5/28/09

Remcon Plastics Inc.
208 Chestnut Street, Reading Pa, 19602

TITLE:
TOOLING BOX
GENERAL SPECIFICATIONS

SIZE DWG. NO. REV
A 512200001001002 A

SCALE: 1:6 WEIGHT: N/A SHEET 1 OF 1

PROPRIETARY AND CONFIDENTIAL
THE INFORMATION CONTAINED IN THIS DRAWING IS THE SOLE PROPERTY OF REMCON PLASTICS INC. ANY REPRODUCTION IN PART OR AS A WHOLE WITHOUT THE WRITTEN PERMISSION OF REMCON PLASTICS INC. IS STRICTLY PROHIBITED.

5

4

3

2

1

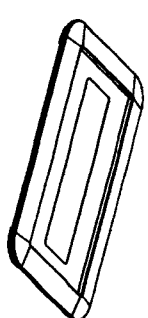
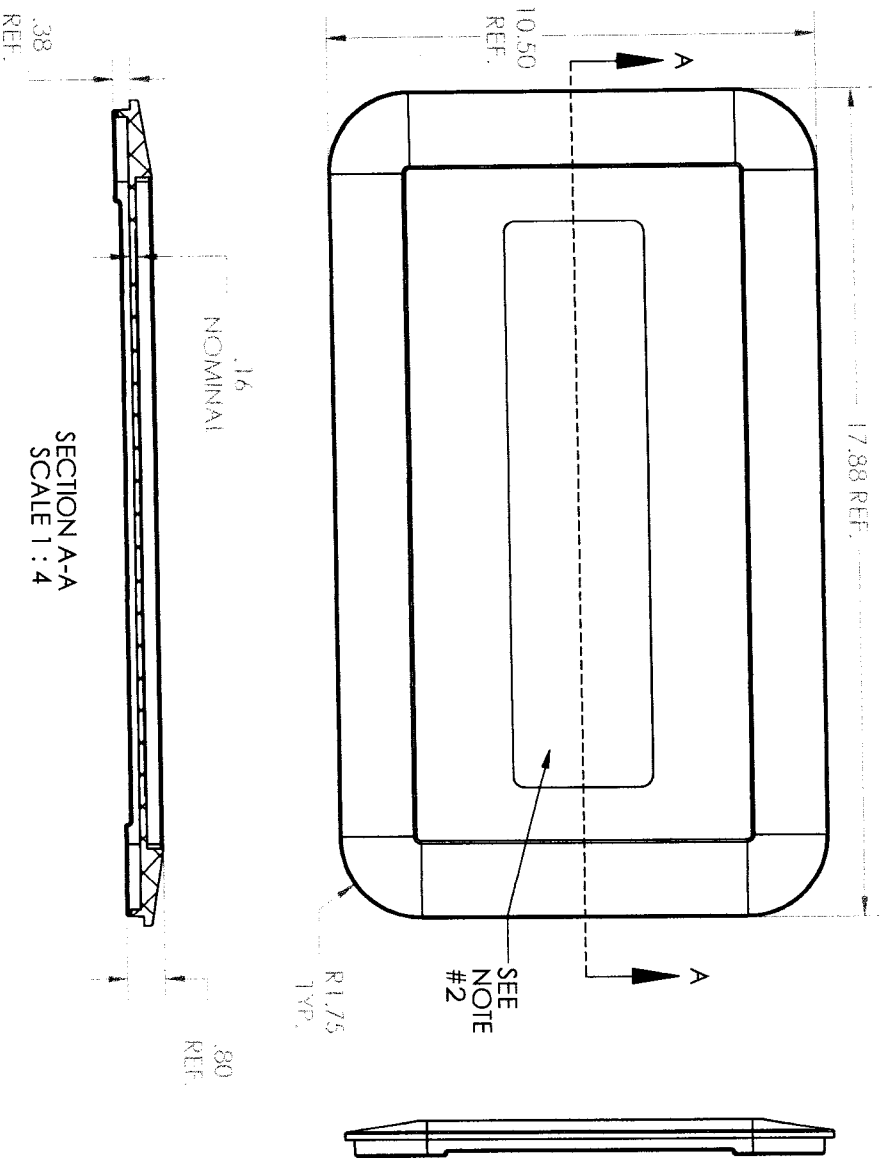

ISOMETRIC SKETCH
(NOT TO SCALE)

- NOTES:
1. DRAWING SHOWS FINISHED MOLDED LID
 2. "XXX" IN DRAWING NUMBER DENOTES LOGO AREA CONFIGURATIONS
 3. FIT WITH CORRESPONDING BOX IS CRITICAL
 4. CORRESPONDING BOX AND TRAY DETAILS PROVIDED ON SEPARATE DRAWINGS.
 5. DIMENSIONS ARE REFERENCE ONLY - REFER TO SOLID GEOMETRY FOR PART DETAILS AND DIMENSIONS NOT SHOWN.

CONFIGURATION TABLE
FOR LOGO AREA:

- 001: REMCON
- 002: NATOLI
- 003: THOMAS
- 004: ELIZABETH
- 005: COURTOY
- 006: KIKUSUI
- 007: HOLLAND
- 008: FETTE

SECTION A-A
SCALE 1 : 4

PROPRIETARY AND CONFIDENTIAL

THE INFORMATION CONTAINED IN THIS DRAWING IS THE SOLE PROPERTY OF REMCON PLASTICS INC. ANY REPRODUCTION IN PART OR AS A WHOLE WITHOUT THE WRITTEN PERMISSION OF REMCON PLASTICS INC. IS STRICTLY PROHIBITED.

UNLESS OTHERWISE SPECIFIED:

DIMENSIONS ARE IN INCHES
TOLERANCES:
FRACTIONAL: N/A
ANGULAR: ± 1/2 deg
TWO PLACE DECIMAL: ± 0.030
THREE PLACE DECIMAL: N/A

ENGINEERING PROJECT #:
MATERIAL POLYPROPYLENE
FINISH SMOOTH

DRAWN
CHECKED
ENG APPR.
MFG APPR.
G.A.
COMMENTS:

NAME	DATE
PFE	5/28/09
PFE	5/28/09
KM	5/28/09

Remcon Plastics Inc.
208 Chestnut Street, Reading Pa, 19602
TITLE:
TOOLING BOX LID
GENERAL SPECIFICATIONS

SIZE DWG. NO. REV

A 512300001XXXX002 A

SCALE: 1:4 WEIGHT: N/A SHEET 1 OF 1

NEXT ASSY

USED ON

APPLICATION

DO NOT SCALE DRAWING

5

4

3

2

1

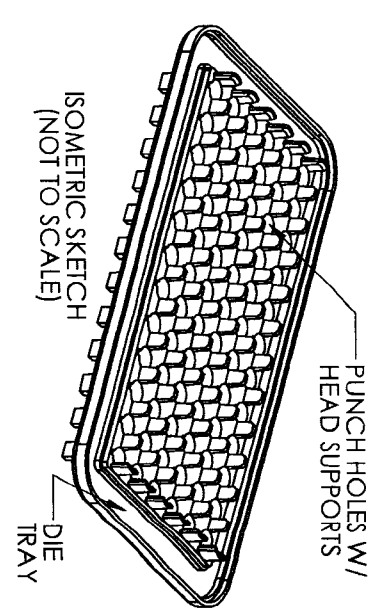
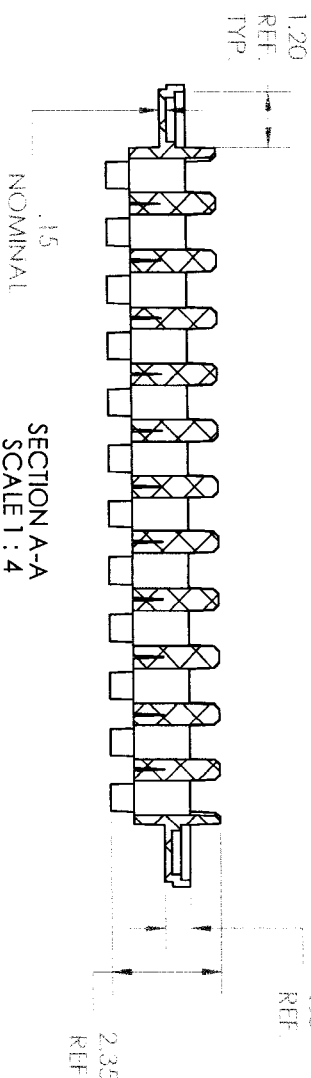
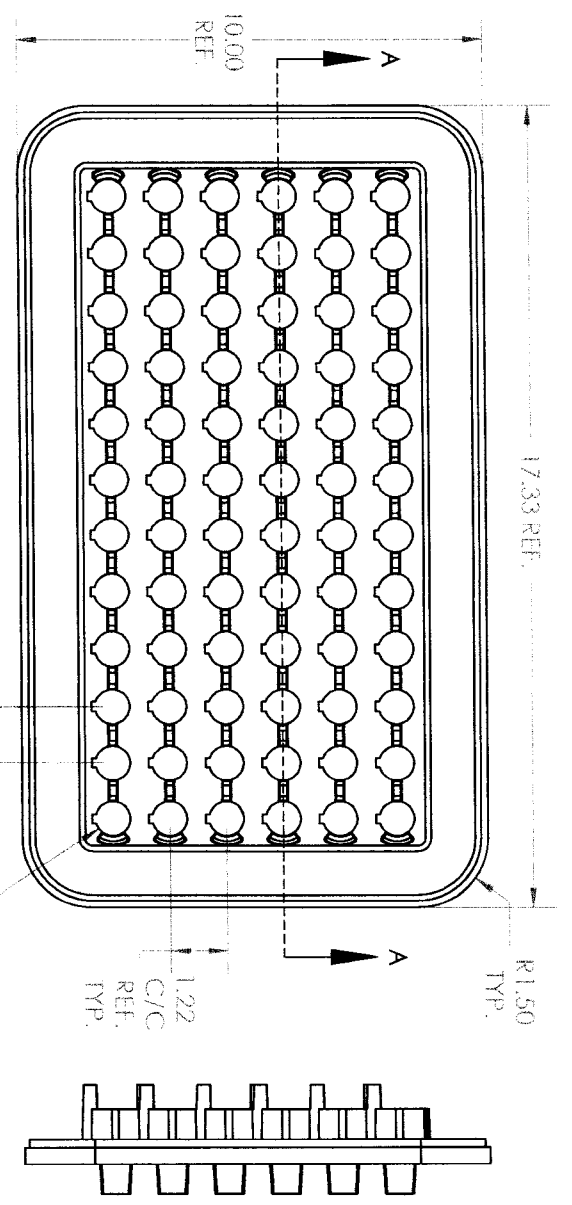

- NOTES:
1. DRAWING SHOWS FINISHED MOLDED TRAY. CORRESPONDING BOX AND LID DETAILS PROVIDED ON SEPARATE DRAWINGS. FIT WITH CORRESPONDING BOX AND LID IS CRITICAL.
 2. DIMENSIONS ARE REFERENCE ONLY - REFER TO SOLID GEOMETRY FOR PART DETAILS AND DIMENSIONS NOT SHOWN.
 - 3.
 - 4.

UNLESS OTHERWISE SPECIFIED:

DIMENSIONS ARE IN INCHES
 TOLERANCES:
 FRACTIONAL: N/A
 ANGULAR: ± 1/2 deg
 TWO PLACE DECIMAL: ± 0.030
 THREE PLACE DECIMAL: N/A

ENGINEERING: PROP.
 PROJECT #: UPDATES
 MATERIAL: POLYPROPYLENE

FINISH: SMOOTH
 DO NOT SCALE DRAWING

NAME: Remcon Plastics Inc.
 DATE: 5/28/09
 208 Chestnut Street, Reading Pa, 19602
 TITLE: TOOLING BOX TRAY
 3/4" - "B" SIZE
 GENERAL SPECIFICATIONS

DRAWN: PEE
 CHECKED: PEE
 ENG APPR: KM
 MFG APPR:
 G.A.
 COMMENTS:

SIZE DWG. NO. **A** 512102010001002
 SCALE: 1:4 WEIGHT: N/A SHEET 1 OF 1

PROPRIETARY AND CONFIDENTIAL
 THE INFORMATION CONTAINED IN THIS DRAWING IS THE SOLE PROPERTY OF REMCON PLASTICS INC. ANY REPRODUCTION IN PART OR AS A WHOLE WITHOUT THE WRITTEN PERMISSION OF REMCON PLASTICS INC. IS STRICTLY PROHIBITED.

NEXT ASSY: 5
 USED ON: 4
 APPLICATION: 3