

DETAIL A
SCALE 1 : 6

NOTES:

1. DRAWING SHOWS FINISHED MOLDED PART - TRIMMED
2. ALL DIMENSIONS ARE TO THEORETICAL SHARP CORNERS
3. CRITICAL DIMENSIONS DENOTED WITH OVALS
4. ALL CORNERS AND EDGES HAVE RADII
5. NOMINAL WALL THICKNESS 0.300
6. CERTAIN LOGICAL HIDDEN LINES OMITTED FOR CLARITY
7. REFER TO PART GEOMETRY FOR ADDITIONAL DETAILS

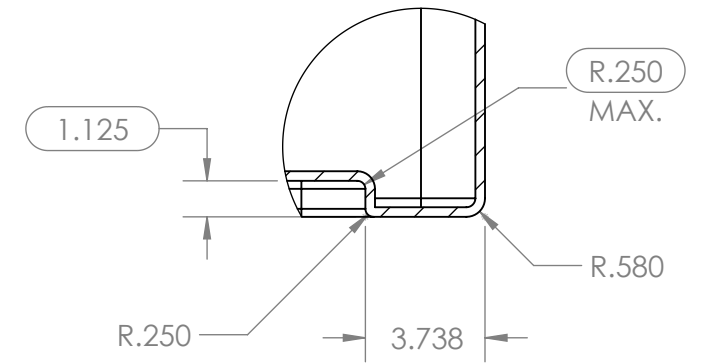

DETAIL B
SCALE 1 : 6

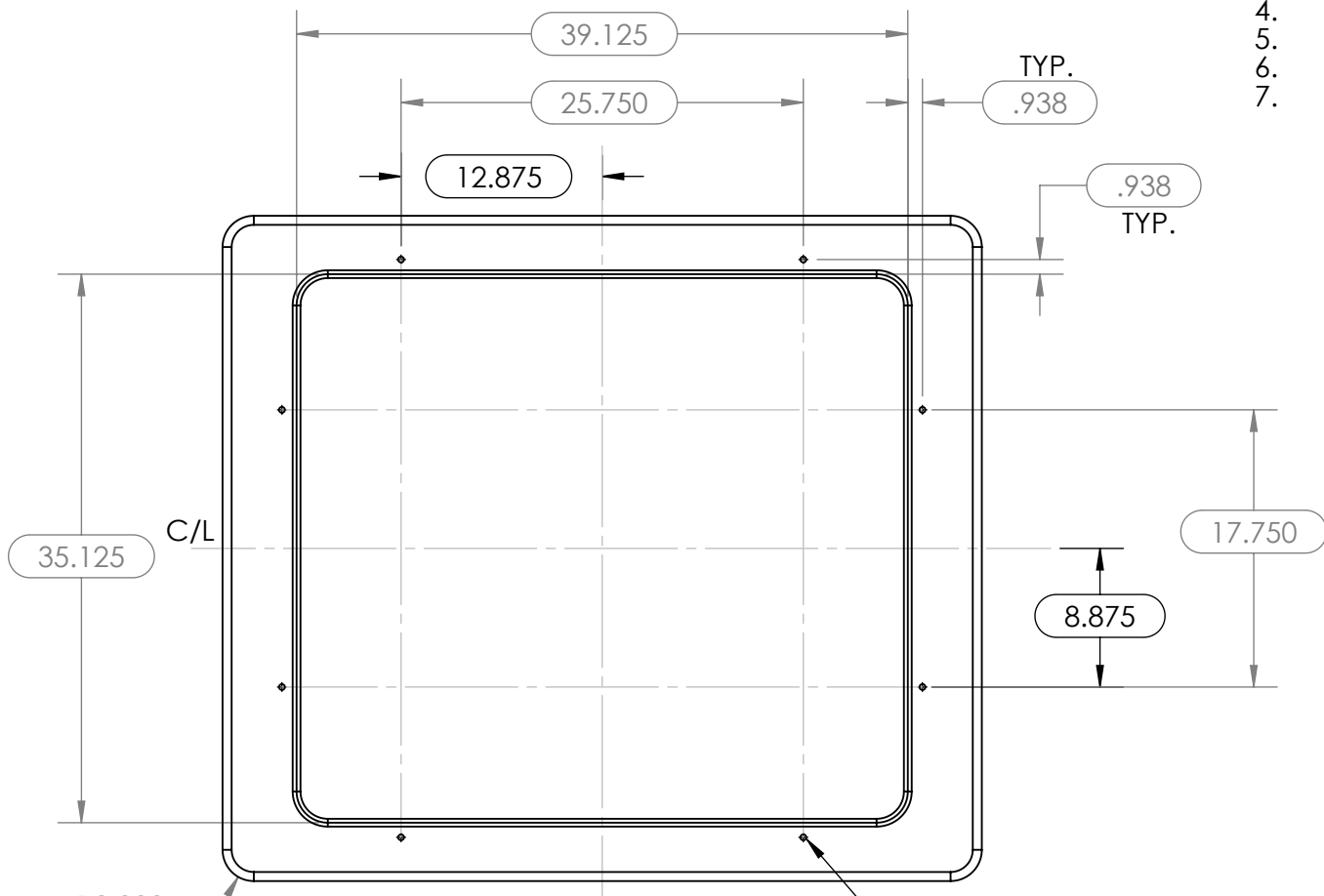

BOTTOM VIEW
(FOR INSERT LOCATIONS
AND PALLET RECESS)

3/8-16 MOLDED
IN INSERT
(TYP 8 PLCS)

PROPRIETARY AND CONFIDENTIAL
THE INFORMATION CONTAINED IN THIS
DRAWING IS THE SOLE PROPERTY OF
REMCON PLASTICS INC. ANY
REPRODUCTION IN PART OR AS A WHOLE
WITHOUT THE WRITTEN PERMISSION OF
REMCON PLASTICS INC IS PROHIBITED.

		UNLESS OTHERWISE SPECIFIED:		NAME	DATE	Remcon Plastics Inc. 208 Chestnut Street, Reading Pa, 19602	
		DIMENSIONS ARE IN INCHES		DRAWN	PFE	2/10/11	TITLE: 20 BIN WITH INSERTS GENERAL SPECIFICATIONS
		TOLERANCES:		CHECKED	PFE	2/10/11	
		FRACTIONAL: N/A		ENG APPR.	KM	2/10/11	
		ANGULAR: ±1/2DEG		COMMENTS:			SIZE DWG. NO. REV B 010702048001XXX C
		2 PLACE DECIMAL: ±0.020 in/in		"XXX" DENOTES COLOR CODE			
		3 PLACE DECIMAL: ±.0010 in/in		PROJECT NUMBER: 2137			SCALE: 1:12 WEIGHT:
		MATERIAL		MATERIAL			SHEET 1 OF 1
		FINISH		FINISH			
NEXT ASSY	USED ON	DO NOT SCALE DRAWING					

8 7 6 5 4 3 2 1

D

D

C

C

B

B

A

A

8 7 6 5 4 3 2 1